

ercol

windsor wall fixings: base cabinets

Thank you for purchasing this ercol product. Please read the instructions carefully before use to ensure safe and satisfactory operation of this product. Installation shall be carried out exactly according to the manufacturers instructions, otherwise a safety risk can occur if incorrectly installed. Cabinets and shelving over 600mm high and should be supported until fixed to the wall.

WARNING: In order to prevent overturning this product must be used with the wall attachment device provided.

These items are heavy



Necessary Tools

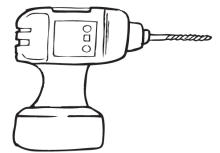
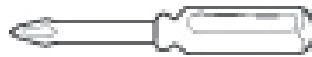

If you have purchased a display cabinet your fitting pack contains

A	x 8 brass shelf supports	
B	x 4 wooden leveller cover discs	

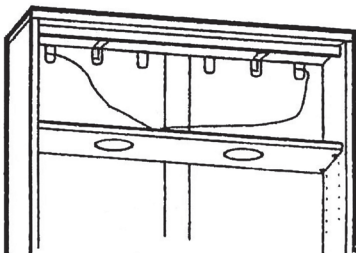

To access the wall fixing brackets, take out the four brass shelf supports and lower the lighting shelf to reveal the sliding fixing plates inside the top of the cabinet.

You will require an extra pair of hands to hold the shelf while another person attaches the cabinet to the wall following the step below.

Replace the shelf/lighting shelf using the brass shelf supports.

Slacken the two screws that hold each of the angled fixing plates and slide the plate back to touch the wall, then re tighten the two screws.

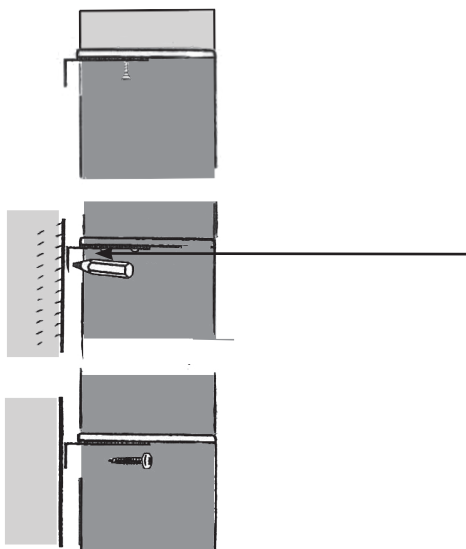

Mark the wall with a pencil through the hole in the fixing plate

Move the unit away from the wall. Check for pipes and electrical cables before drilling the wall.

Drill the wall for a fixing appropriate to your walls construction.

Place unit in its final position and make sure it is still level. Fix cabinet to the wall by screwing through the metal plate where applicable.

Levelling the cabinet



All windsor base cabinets are fitted with four adjustable levellers which can be operated from inside of the cabinet using a straight bladed screwdriver.

This helps to ensure doors do not bind when they are opened. Four polished plugs are supplied to cover the access holes once you are satisfied that your cabinet is level.



Change the light bulbs

Switch spotlights off and let them cool down.

Do not switch on without the diffuser ring and glass. USE ONLY 12V 10W lamps

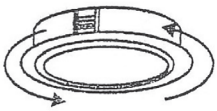

Turn diffuser ring anti-clockwise until it stops

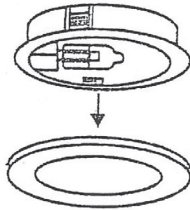

Carefully pull diffuser ring with glass out of the spotlight housing

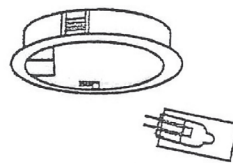

Remove the spent lamp and replace it with a new G4 halogen lamp (10W) only. Do not touch bulb with our fingers but use a cloth or paper.

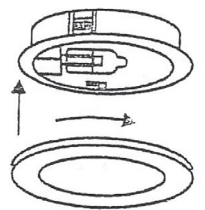

Fit locking cams of diffuser ring into the openings of the housing and turn them clockwise until it stops